



Antarctica
New Zealand

**Scott Base is Aotearoa
New Zealand's home
in Antarctica.**

**While only a small
percentage of kiwis
have travelled to
the ice, many feel a
strong connection to
Scott Base.**

SCOTT BASE REDEVELOPMENT COMMUNICATIONS



The Scott Base Redevelopment will see the aging infrastructure replaced with a safe, fit-for-purpose, and sustainable research facility that will support Aotearoa New Zealand's presence in the Ross Sea region of Antarctica for the next 50 years.

The existing base, made up of 12 separate buildings, will be replaced by three large interconnected buildings.

The project includes an upgrade to the Ross Island Wind Energy system that powers Scott Base and the United States' McMurdo Station with renewable energy.

Antarctica New Zealand works to raise awareness of Antarctica, Aotearoa's activities on the ice, and its scientific research programme.

Building a connection between kiwis and the redevelopment is a key part of the project.

A 3D look inside the future Scott Base

Scan the codes for a virtual tour

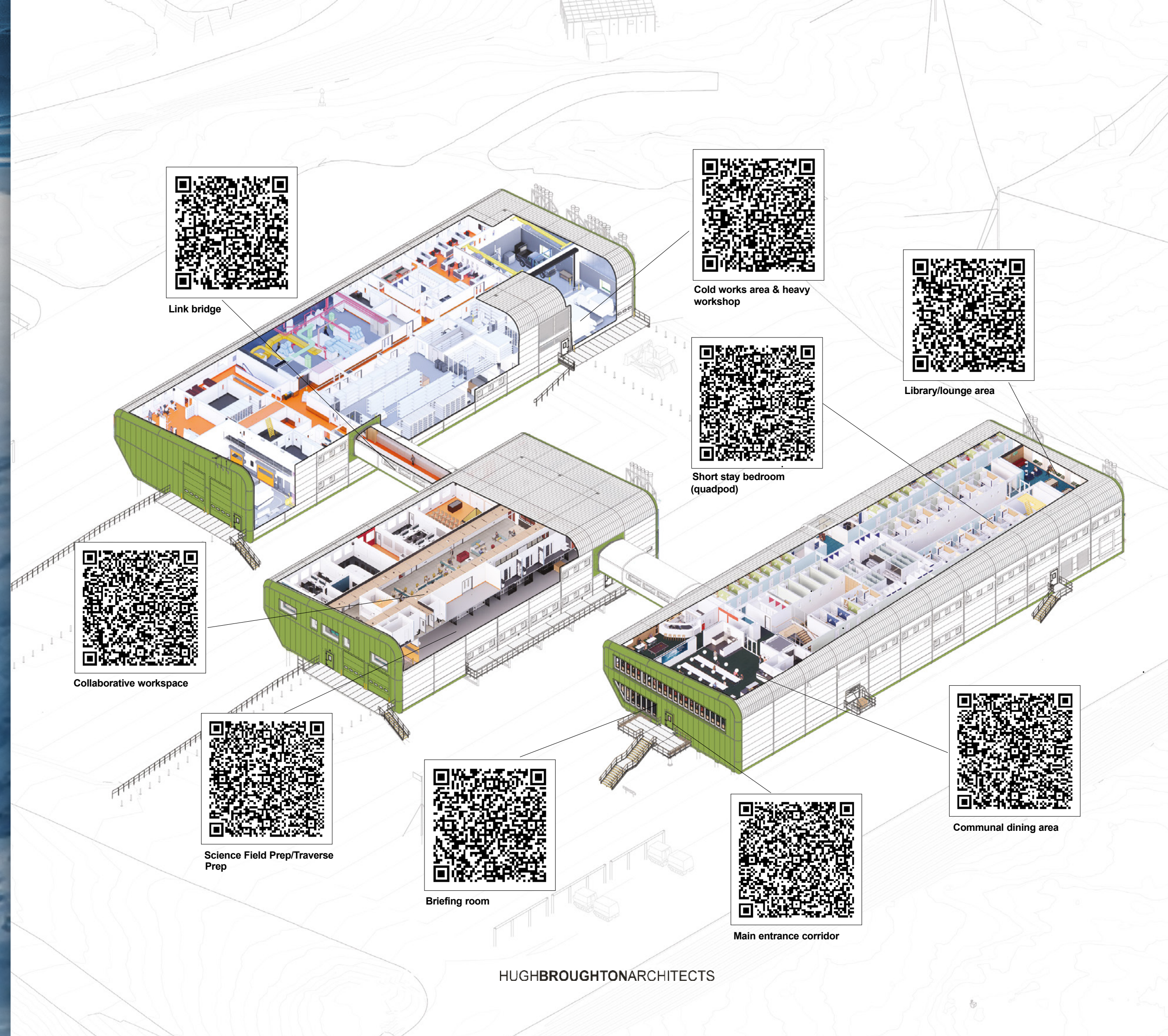

Can Kids Ace Scott Base?

Ōtautahi Christchurch is one of five Antarctic Gateway Cities. It's home to the International Antarctic Centre – a tourist attraction that inspires visitors to become passionate advocates for Antarctica.

Antarctica New Zealand set up the 'Ace the Base' exhibit at the attraction to showcase the Scott Base redevelopment to kids and their families.

Ace the Base gives children the chance to build their own Scott Base using DUPLO and learn about Antarctica along the way.



Miniature Scott Base

An architectural model was created to exhibit the design of New Zealand's future Antarctic research station

The model has been built to scale and is displayed at public events and in the Antarctica New Zealand office in Christchurch.



Building Scott Base in Minecraft

The excitement of the new base being built in Timaru, New Zealand inspired local students to construct it themselves using Minecraft Education Edition.

Antarctica New Zealand provided the floor plans and the school students, ranging from Year 5 to Year 10, created the outer shell of the new base.

They applied their maths skills by using scale and ratio for the interiors of the buildings.

The students used editing software to create and animate Antarctic fauna, such as the Adelie penguin.

Around 400 students worked on the final product that will be submitted for publication on the Minecraft Educator website and will be freely available to everyone.

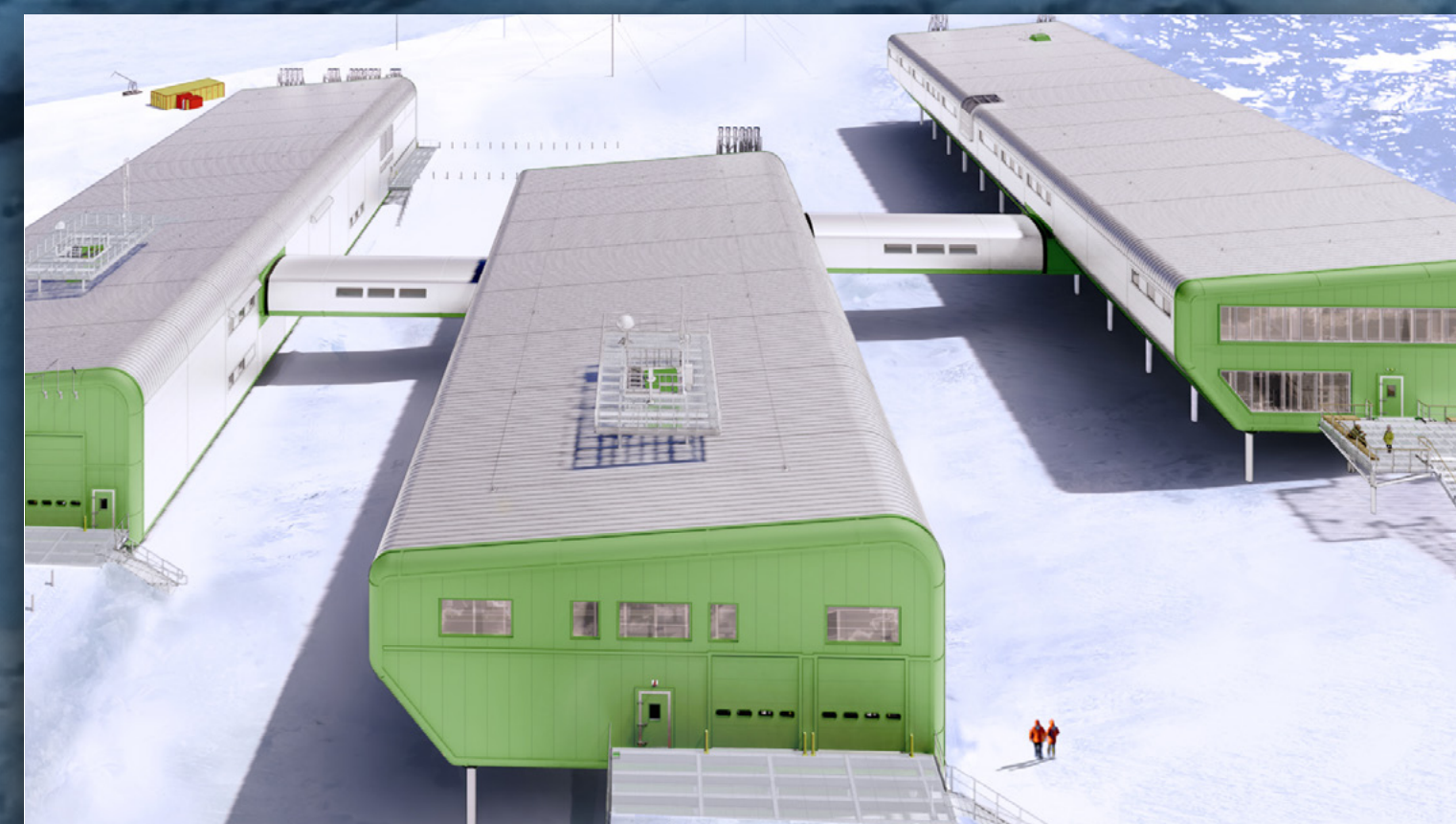
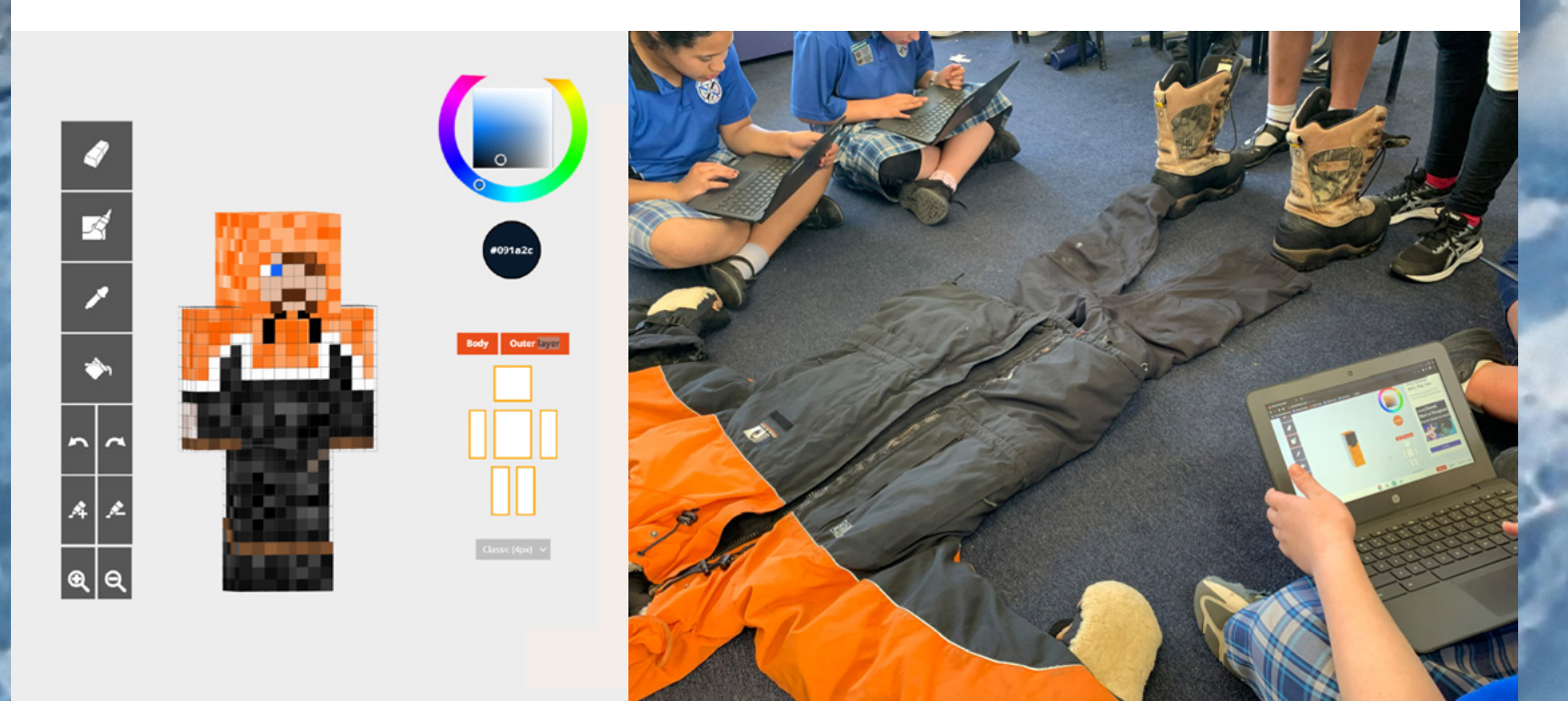

Colour our Place, Scott Base

Antarctica New Zealand asked New Zealanders to vote on the colour of the new Scott Base.

Colour our Place, Scott Base aimed to include the public in the design process and raise awareness of Antarctica New Zealand's activities and Antarctic science programme. Kiwis could choose Kākāriki-Green, Karaka-Orange, or Kikorangi-Blue.

The campaign was launched on national television, driven by digital media, and supported by strategic partners. Timing coincided with the New Zealand Primary Schools Science Week, themed on Antarctica.

Kiwis decided to keep Scott Base kākāriki-green – a tribute to it's not too distant past.

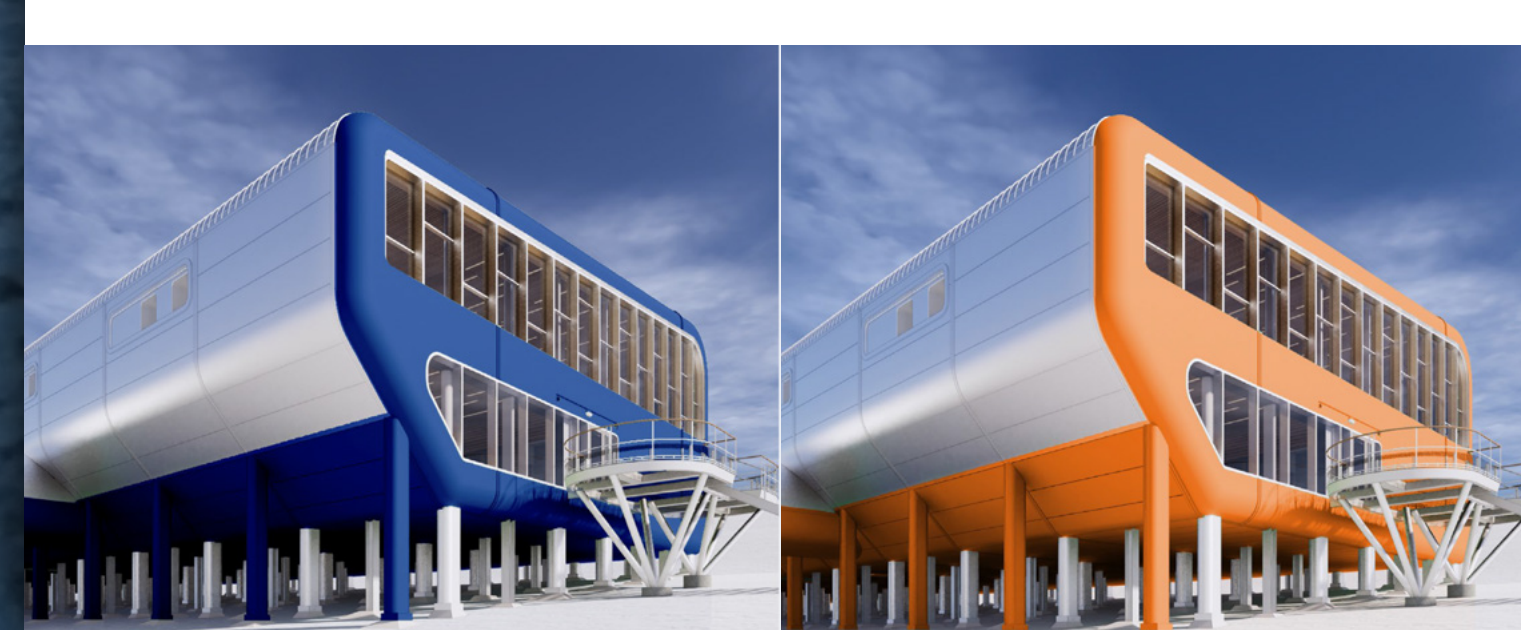

Bringing People on a Journey

Create a New Zealand identity, foster a sense of community and involve stakeholders were important aspects of the design brief.

The project design team led multiple user-group workshops with over 130 people, including current and former staff, scientists, heritage specialists and other subject matter experts.

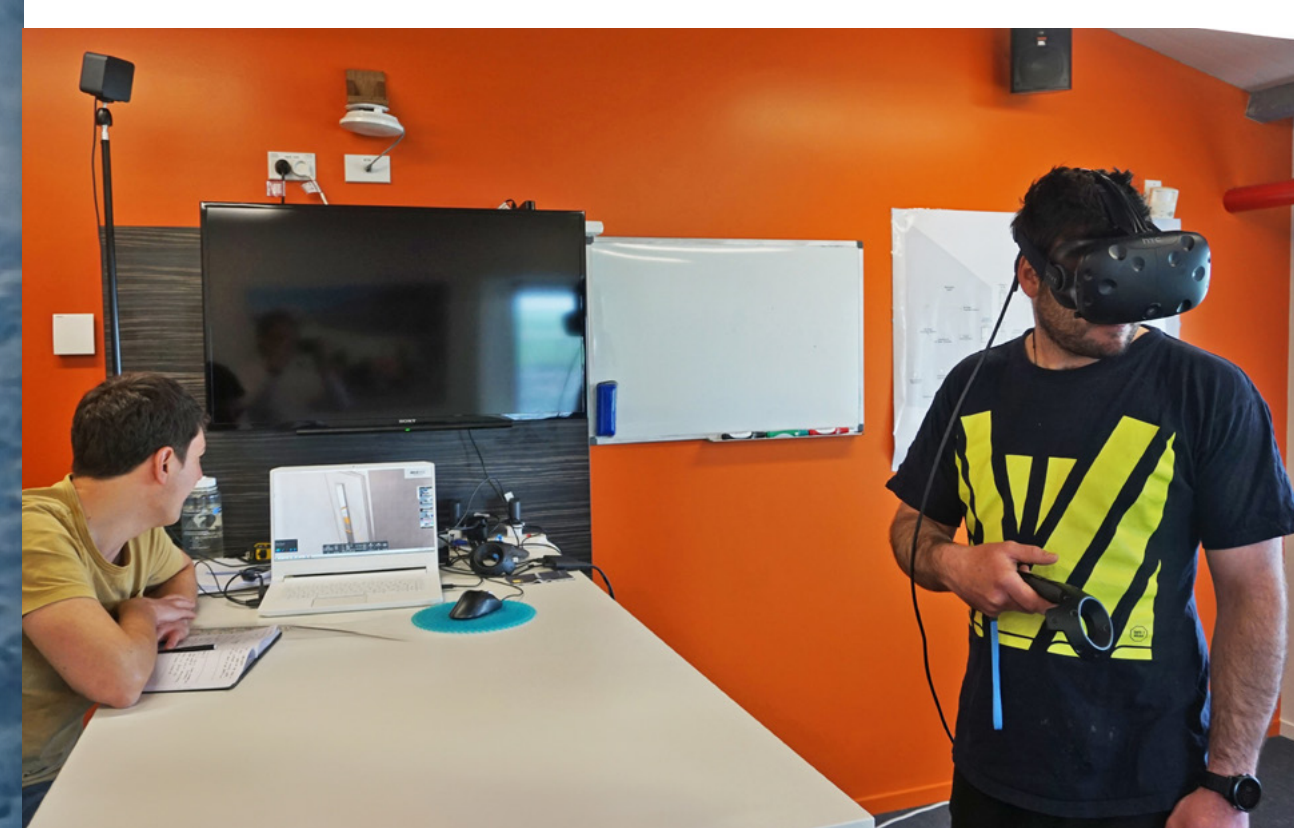

A virtual experience, using Enscape3D, allows users to wander through the buildings, giving a feel of the size and layout of the new facility.

Full-scale cardboard copies of base spaces were set up in a Christchurch warehouse to provide users with the physical feel and another opportunity to give feedback.

Inside were mock ups for bedrooms, including short-stay quad bunks for visiting research teams and long-stay single rooms for staff staying up to 13 months.

The Ice House

Scott Base was ground breaking when it was established in 1957. How will the new station continue that legacy?

New Zealand production company Imagination TV will tell the story of the Scott Base Redevelopment project through a four-part docuseries.

A camera crew will travel to the ice each summer to film the construction work and Antarctic science, and interview the people behind the project. A competitive tender process was followed and funding was secured independently.

The docuseries will air after the completion of the project in 2028.



Find out more about

www.antarcticanz.govt.nz

www.scottbaseredevlopment.govt.nz

Acknowledgements

Thank you to the Scott Base Redevelopment design and construction partners for their contributions to the communications and engagement for the project: Hugh Broughton Architects, Steensen Varming, WSP New Zealand, the Building Intelligence Group, AECOM, and Leighs Construction.